

Subwork 10: Accessories, Machineries and Equipment's for processing facility

Sr.No.	Description	Unit	Quantity	Unit Rate	Amount in Lakhs Rs.
1	Mesh bins for segregated dry waste	nos	28	3101.22	2.27
2	4 mm sieve (Steel)	nos	3	4607.45	0.14
3	16 mm sieve (Steel)	nos	3	2390.64	0.07
4	35 mm sieve (Steel)	nos	3	1677.75	0.05
			Total		2.53

[Signature]

[Signature]

21/11/2011
 2.53
 51-
 251-

Rate Analysis for 16mm Sieve

Sieve is 1 m wide and 1.5m high

Sr. No.	Description	Value	Unit	Reference
1	Cross Section area of wire (4mm)	1.25714E-05	sq.m	
2	Length of wire	147.5	m	
3	Volume of wire	0.001854	cu.m	
4	Density of steel wire	7850	kg/cu.m	
5	Weight of wire	14.556	kg	
6	Length of Angle (25mm*25mm*4mm)	5	m	
7	Weight of angle	1.4	kg/m	IS 808:1989; Section 5 (equal leg angles) (Pg.8)
8	Total Weight of angle	7	kg	
9	Total weight of steel	21.556	kg	
10	Cost of steel	86.05	Rs./kg	CPWD DSR Volume 1, 2018: Subhead 10.0 Steel Work, 10.1 (Pg 183)
11	Cost of steel in 16 mm sieve	1854.91	Rs.	
12	Cost Index Rishikesh	0.00		
13	Cost	1854.91		
14	Fabrication cost (15% extra)	278.24	Rs.	
15	Half day blacksmith	257.50	Rs.	
16	Total cost of 16 mm sieve	2390.64	Rs.	

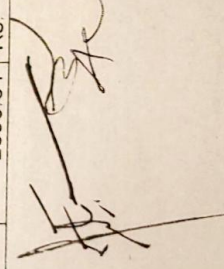

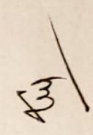



Rate Analysis for 35mm Sieve

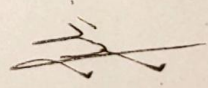

Sieve is 1 m wide and 1.5m high

Sr. No.	Description	Value	Unit	Reference
1	Cross Section area of wire (4mm)	1.25714E-05	sq.m	
2	Length of wire	74.5	m	
3	Volume of wire	0.000937	cu.m	
4	Density of steel wire	7850	kg/cu.m	
5	Weight of wire	7.352	kg	
6	Length of Angle (25mm*25mm*4mm)	5	m	
7	Weight of angle	1.4	kg/m	IS 808:1989, Section 5 (equal leg angles) (Pg.8)
8	Total Weight of angle	7	kg	
9	Total weight of steel	14.352	kg	
10	Cost of steel	86.05	Rs./kg	CPWD DSR Volume 1, 2018: Subhead 10.0 Steel Work, 10.1 (Pg 183)
11	Cost of steel in 35 mm sieve	1235.00	Rs.	
12	Cost Index Rishikesh	0.00		
13	Cost	1235.00		
14	Fabrication cost (15% extra)	185.25	Rs.	
15	Half day blacksmith	257.50	Rs.	
16	Total cost of 35 mm sieve	1677.75	Rs.	



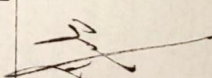

Subwork 11: IEC Activity for Swargashram

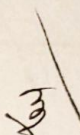

Sr. No	Activity	Activity Details	Unit	Estimated Quantity	Rate in INR.	Amount (in INR).	Remarks
A) Visual/Audio Visual media							
1	Production of Television spots	Design, script, shoot, edit, prepare 30-60 second television spots, shot on Digibeta OR DV Cam in HD format, in Hindi/local language, involving renowned local professional artists, based on a minimum of 7 different themes (i.e. ODF, handwashing, SWM awareness and good practices) as required by the Client/ULB, to be aired on national and local channels	No	X	300000.00	300000	Market Survey, agencies contacted, 1-Channel Mountain, Dehradun,
B) Audio Media							
2	Production of Audio (success stories on SBM-U and awareness)	30 second Radio Jingles will be produced by the consultant on the Themes (i.e. ODF, handwashing, SWM awareness and good practices) to be identified by the client in Hindi/local language, to be aired through All India Radio local stations	No	X	300000.00	300000	Market Survey, agencies contacted, 1-Channel Mountain, Dehradun,
C) Outdoor Media							
3	Hoardings/ banners or other Out of Home (OOH) advertising like hot air balloons/ other innovative ad spaces	Design, script the content in local languages, based on the theme as provided by the ULBs/Client. The Out-of-home (OOH) advertising will be printed in colour, in the form of hoardings, in sizes, as required by the Client to be printed on cloth and installed/mounted by the Consultant; minimum 20 locations in each ULB, as directed by the Client	sq. ft			200000	Govt. rates
D) Print Media							

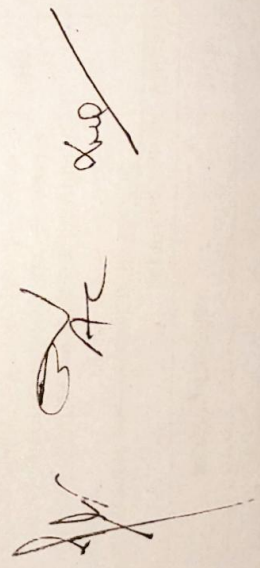
Sr. No	Activity	Activity Details	Unit	Estimated Quantity	Rate in INR.	Amount (in INR).	Remarks
4	Printing of awareness posters	Coloured (A3size, 17CGSMGLOSSY/MATTLAMINATEDPAPER)withphotos, textregardingSWMBestPractices, Designing, Printing, Distributionamong targetgroupsinEnglish, Hindi, basedonthecontents appliedbytheClient/ULBsandscribedbytheconsultant, inlotsof100, foreacheULB.	Lot	200	50	10000	Local rates to be collected
5	Printing of Newsletter	Coloured- 8pages, (A4size)in300GSMGlossypaper, withphotos, textregardingSWMBestPracticesandprojectinformation, Designing, Printing, Distributionamong targetgroupsinEnglish, Hindi, basedonthecontents appliedbytheClient/ULBsandscribedbytheconsultant, atleastoncein each quarter for each ULB, in lots of minimum 500 copies.	No	12X 1000	12	144000	As per SPMG-NGCA
F) Mass Contact Program							
6	Cleanliness/Awareness drives in Govt. hospitals/unclean sites	To be conducted once in each ULB, consisting of "Walk of Shame" through unclean sites, lecture/training session with a cleaning drive involving Government staff, school children, Municipal employees, local community members, shopkeepers, volunteers, NGOs etc. with 02 event banners, 10 awareness cloth banners (not flex/PVC), all necessary Audio Visual equipment, Cleanliness equipment like brooms, brushes, cleaning materials, with a minimum of 200 people, refreshment for participants (usage of disposable items of plastic and thermocol is not allowed during the event), requisite manpower to execute the activity will be provided by the consultant.	No	Lumpsum	100000.00	100000.00	



Sr. No	Activity	Activity Details	Unit	Estimated Quantity	Rate in INR.	Amount (in INR).	Remarks
7	Open School painting/poster slogan writing and quiz Competition	ULB develop School painting/poster Competition, Quiz Competition, slogan writing competition in groups of 6 to 8 class and 9 to 12 class (covering all Government school, maximum students 5 from each school), all three competition will be organized on the same day, will have to organize once in each ULB, by the consultant. The painting from the competition will be evaluated by the agency by a panel of experts nominated by the Consultant and approved by the Client. A exhibition of the paintings will be held and awards will be given under various age groups for the best three paintings. All the required stationary, 02 event & 05 awareness cloth banners (not flex/PVC) size 5x3 feet, Refreshment for participants (usage of disposable items of plastic and thermocol is not allowed during these events), with a minimum of 150 students and requisite manpower will be provided by the consultant.	No		200000	200000	
8	Street plays/ Nukkad Natak	Utilising folk art forms, songs, dramas, entertainment performances etc. to which the local populace are able to identify, of minimum 30 minutes duration (in Hindi/Local language) with at least 8-10 characters will be scripted by the agency focusing on different components of SBM and SWM "Good Practices" as adopted by communities. The play will have to be performed in various crowded places of ULB by professional actor employed by the Consultant, in a minimum of 50 persons, at least once in each month in each ULB. The Consultant will also be responsible for designing, printing/preparation and fixing in place of 02 event banners, 10 awareness cloth banners (not flex/PVC) for each play, as approved by the client.	No		10000	120000	

Sr. No	Activity	Activity Details	Unit	Estimated Quantity	Rate in INR.	Amount (in INR).	Remarks
9	Seminar/ Workshop	ULB level seminars/workshops (Venue to be finalised and provided by Client/ULB free of cost), involving district/block level officers concerned, NGOs, CBOs, researchers, academicians, prominent local people and public representatives, will be organized, by the consultant at least once in each ULB, focusing on "Good Practices" of SWM, with special focus on "Community Participation", (minimum 60 -75 participant) with all necessary Audio Visual equipment, refreshment, manpower essential to execute the activity. Prominent National Specialists will be engaged as individual consultants to address the gathering. Plastic & Thermocol disposal items is prohibited in all events.	No	12	5000	60000	
10	Press Briefing/ Press Event/Press Conference	Organising pressevent for 10-15 media at different locations, Preparation of press materials approved by Client/ULBs. (Venue to be finalised and provided by Client/ULB free of cost) with stage (if required), backdrops, registration desk and audio-video equipment, refreshments for media. Media interviews, RSV and giveaways, Distribution of material to all local media and reporting coverage	No	12	2500	30000	
11	Press Release	Finalising content and ensuring publicity by Press Release, as a tool of public awareness, as directed by the Client/ ULB	No	12	2500	30000	
12	Mobile based Outreach campaign.	Creation and execution of SMS/calling mobile outreach campaigns reaching out to a minimum of 10,000 people in each campaign, once in each quarter, in 24 ULBs.	No	Lumpsum		100000	
Total						1594000	

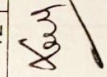
994000, 1594000
 S/- Nil -
 WS/- 89,94 lacs

[Handwritten signatures]



Subwork 12: Electric Cost

Sl. No.	Work Description	Unit	Qty.	Rate in Rs.		Amount in Rs		Item Reference
				DSR	NSI	DSR	NSI	
1	Supplying installation testing and commissioning of LT Panel, Automatic power factor corrector panel, Essential Panel i/c Earthing, inter connecting power cables in sub-station, safety equipments.	KVA	20	9000		180000		DSR E/M Plinth area rates 2019- sl. 1
2	Wiring for light point/ fan point/ exhaust fan point/ call bell point with 1.5 sq.mm FRLS PVC insulated copper conductor single core cable in surface / recessed medium class PVC conduit, with modular switch, modular plate, suitable GI box and earthing the point with 1.5 sq.mm FRLS PVC insulated copper conductor single core cable etc. as required							
	Light Point/Fan Points -							
	Group B							
3	Wiring for light/ power plug with 2X4 sq. mm FRLS PVC insulated copper conductor single core cable in surface/ recessed medium class PVC conduit alongwith 1 No 4 sq mm FRLS PVC insulated copper conductor single core cable for loop earthing as required.	m	30	265.00		7950		DSR 18_Item No_1.5
4	Supplying and fixing following modular switch/ socket on the existing modular plate & switch box including connections but excluding modular plate etc. as required.							
	5/6 A switch	No	3	85.00		255		DSR 18_Item No_1.24.1
	3 pin 5/6 A socket outlet	No	3	111.00		333		DSR 18_Item No_1.24.4
	15A Switch	No	2	132.00		264		DSR 18_Item No_1.24.5

Sl. No.	Work Description	Unit	Qty.	Rate in Rs.		Amount in Rs		Item Reference
				DSR	NSI	DSR	NSI	
	15A Socket	No	2	175.00		350		DSR 18_Item No_ 1.24.4
5	Supplying and fixing suitable size GI box with modular plate and cover in front on surface or in recess, including providing and fixing 6 pin 5/6 & 15/16 A modular socket outlet and 15/16 A modular switch, connections etc. as required.	No.	4	401.00		1604		
6	Supplying and fixing of following sizes of medium class PVC conduit along with accessories in surface/recess including cutting the wall and making good the same in case of recessed conduit as required 25mm	m	50	90.00		4500		DSR 18_Item No_ 1.31
7	Supplying and drawing following sizes of FRLS PVC insulated copper conductor, single core cable in the existing surface/ recessed steel/ PVC conduit as required. 3 x 1.5 sq. mm 2x4 sqmm	m	30	54.00		1620		DSR 18_Item No_ 1.17.3
		m	20	86.00		1720		DSR 18_Item No_ 1.17.20
8	Wiring for circuit/ submain wiring alongwith earth wire with the following sizes of FRLS PVC insulated copper conductor, single core cable in surface/ recessed medium class PVC conduit as required 4x2.5 Sq.mm.	m	25	339.00		8475		DSR 18_Item No_ 1.7.7

Handwritten signatures and initials

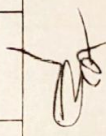
Sl. No.	Work Description	Unit	Qty.	Rate in Rs.		Amount in Rs		Item Reference
				DSR	NSI	DSR	NSI	
9	Providing and fixing following capacity TP&N disconnector fuse switch unit inside the existing panel board with ISI marked HRC fuses including drilling holes in cubicle panel, making connections, etc. as required.							
	32A	no.	2	2,075.00		4150		DSR 18_Item No_2_1.1
	63A	no.	1	2,923.00		2923		DSR 18_Item No_2_1.2
10	Providing and fixing M.V. danger notice plate of 200 mm X 150 mm, made of mild steel, at least 2 mm thick, and vitreous enameled white on both sides, and with inscription in single red colour on front side as required	no	4	226.00		904		DSR 18_Item No_2_21
11	P&F of Heavy duty capacitor start 900/1400 RPM single phase ISI marked Exhaust fan, ISI 2312 marked including making connections testing etc. as required.	no.	2		2,873.50		5,747.00	NSI
12	P & F of IP20 LED batten type light fixture made from CRCA sheet stile housing suitable for mounting LED tube system (integral driver), Power consumption of 18W/36W, 1500/3000 lumens, system lumen efficiency 80 lm/ watt output, life time of 50000 burning hours with 70% initial lumen maintained. CCT 3000° K, 4000° K and 6000° K 2x18W	no	80		1,027.00		82,160.00	NSI

Sl. No.	Work Description	Unit	Qty.	Rate in Rs.		Amount in Rs		Item Reference
				DSR	NSI	DSR	NSI	
13	BULK HEAD - P & F of IP65 IK10 rated LED bulk head type light fixture made from CRCA sheet steel housing suitable for mounting LED tube system (integral driver). Power consumption of 10-15W. 500-600 lumens system lumen efficiency 70 lm/ watt output suitable for 1x100 W GLS/ 9W CFL bulk head fixtures, life time of 50000 burning hours with 70% initial lumen maintained. CCT 3000° K, 4000° K and 6000° K. Fixture shall be in compliance with CE & KEMA standards	no.	2		1,399.90		2,799.80	NSI
14	Supply and erection of Decorative Cast Iron pole as per approved design of following length with base plate on the cement concrete foundation of M-15 grade (1:1:5:3) with the help of anchor bolts of grade 6.8 (IS 1367 P III) The pole shall be made of Cast Iron as per IS 210:1993, precision machining and filling job to achieve good finish and a fine coat of primer on each element before assembling. After assembling of each element one coat of primer and two coats of P.U. paint are applied. Approved coloured UV resist coating of mat/ glossy/ metallic finish followed after air drying of pole. The pole shall have a weatherproof flush door and locking arrangements, two/ one arm bracket of length of 430/380mm complete in all respect. 8M	no.	5		43,462.00		217,310.00	NSI

 Handwritten signature and initials.

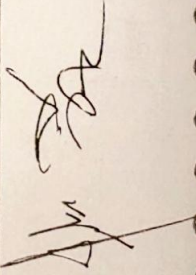
 Handwritten signature and initials.

Sl. No.	Work Description	Unit	Qty.	Rate in Rs.		Amount in Rs		Item Reference
				DSR	NSI	DSR	NSI	
15	Supplying and fixing following way, horizontal type three pole and neutral, sheet steel, MCB distribution board, 415 V, on surface/ recess complete with tinned copper bus bar, neutral bus bar, earth bar, din bar, interconnections, powder painted including earthing etc as required (But without MCB/RCCB/Isolator)	no	2	3,068.00		6,136.00		DSR 18_Item No_2.4.1
16	Supplying and fixing 5 A to 32 A rating, 240/415 V, 10 kA, "C" curve, miniature circuit breaker suitable for inductive load of following poles in the existing MCB DB complete with connections, testing and commissioning etc. as required	no	8	826.00		6,608.00		DSR 18_Item No_2.10.4
17	Earthing with G.I. earth pipe 4.5 metre long, 40 mm dia including accessories, and providing masonry enclosure with cover plate having locking arrangement and watering pipe etc with charcoal/ coke and salt as required	no.	2	5,308.00		10,616.00		DSR 18_Item No_5.2
18	Providing and fixing 6 SWG dia G.I. wire on surface or in recess for loop earthing as required	m	40	57.00		2,280.00		DSR 18_Item No_5.16
19	Service line charges overhead line	m	100		1,500.00		150,000.00	NSI
20	Service line charges overhead underground	m	10		4,000.00		40,000.00	NSI
21	Overhead line (Initial Security)	Rs/KW	12		1,000.00		12,000.00	NSI
	Total of DSR Items					315648.00		
	Total of NSI Items						510016.80	

51 - 135648.00 or Rs 1.36 lakhs
 NSI - 488016.80 Rs 4.88 lakhs
 NSI (Debo) 202,000.00 or Rs 2.02 lakhs

[Handwritten signature]

2012
 2012

मगर आयुक्त
 तगर निगम, ऋषिकेश

Depo 10
 11
 17

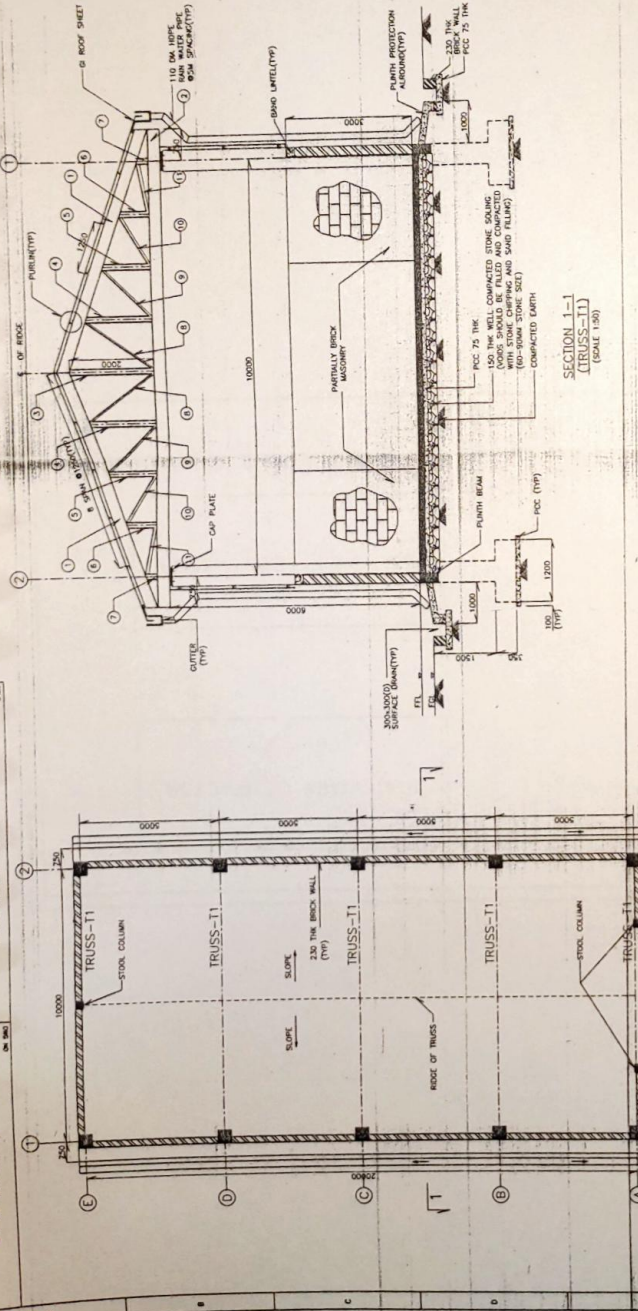
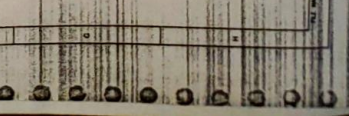
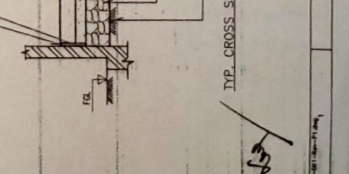
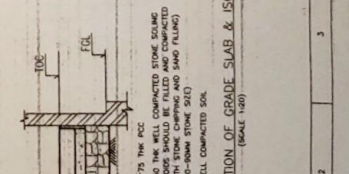
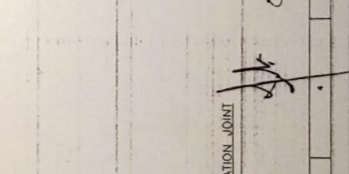
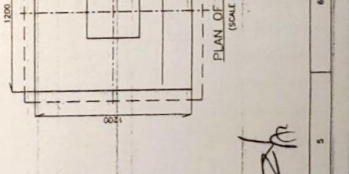
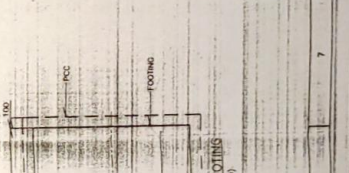
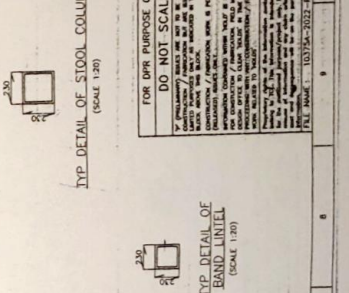
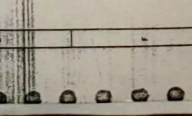
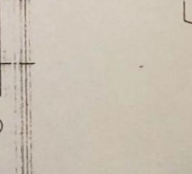
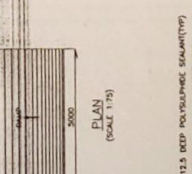
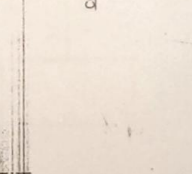
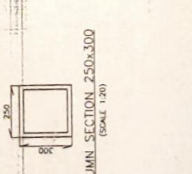
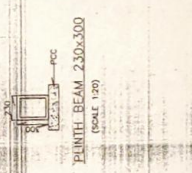

TABLE OF MEMBERS

NUMBER	MEMBER	MARKET
1	PLINTH BEAM	230x300x300
2	TRUSS	RSJ 75x75x8 THK
3	ROOF SHEET	60x60x606 THK
4	PLINTH BEAM	230x300x300 THK
5	TRUSS	RSJ 75x75x8 THK
6	ROOF SHEET	60x60x606 THK
7	PLINTH BEAM	230x300x300 THK
8	TRUSS	RSJ 75x75x8 THK
9	ROOF SHEET	60x60x606 THK
10	PLINTH BEAM	230x300x300 THK
11	TRUSS	RSJ 75x75x8 THK
12	ROOF SHEET	60x60x606 THK
13	PLINTH BEAM	230x300x300 THK
14	TRUSS	RSJ 75x75x8 THK
15	ROOF SHEET	60x60x606 THK
16	PLINTH BEAM	230x300x300 THK
17	TRUSS	RSJ 75x75x8 THK
18	ROOF SHEET	60x60x606 THK
19	PLINTH BEAM	230x300x300 THK
20	TRUSS	RSJ 75x75x8 THK
21	ROOF SHEET	60x60x606 THK
22	PLINTH BEAM	230x300x300 THK
23	TRUSS	RSJ 75x75x8 THK
24	ROOF SHEET	60x60x606 THK
25	PLINTH BEAM	230x300x300 THK
26	TRUSS	RSJ 75x75x8 THK
27	ROOF SHEET	60x60x606 THK
28	PLINTH BEAM	230x300x300 THK
29	TRUSS	RSJ 75x75x8 THK
30	ROOF SHEET	60x60x606 THK



LEGEND:
 Hatched - concrete
 --- - brick
 --- - plaster
 --- - floor finish
 --- - roof finish
 --- - wall finish
 --- - ceiling finish
 --- - floor slab
 --- - roof slab
 --- - wall slab
 --- - ceiling slab
 --- - floor slab
 --- - roof slab
 --- - wall slab
 --- - ceiling slab

NO.	REVISION	DATE	BY	CHKD	APPD	DATE
1						
2						
3						
4						
5						
6						
7						
8						
9						
10						
11						
12						
13						
14						
15						
16						
17						
18						
19						
20						

FOR DPR PURPOSE ONLY
DO NOT SCALE

THE CONTRACTOR SHALL BE RESPONSIBLE FOR OBTAINING ALL NECESSARY PERMITS AND APPROVALS FROM THE LOCAL AUTHORITIES AND THE NATIONAL BUREAU OF STANDARDS (NBS) BEFORE COMMENCING WORK. THE CONTRACTOR SHALL BE RESPONSIBLE FOR OBTAINING ALL NECESSARY PERMITS AND APPROVALS FROM THE LOCAL AUTHORITIES AND THE NATIONAL BUREAU OF STANDARDS (NBS) BEFORE COMMENCING WORK.

ULTRARASHID URBAN SECTOR DEVELOPMENT AGENCY (UUSDA)
ULTRARASHID URBAN SECTOR DEVELOPMENT INVESTMENT PROGRAM (UUSIP)

TYPICAL GENERAL ARRANGEMENT
OF WASTE TRANSFER SHED

TATA CONSULTING ENGINEERS LIMITED
MUMBAI

ICE.10375A-CH-2022-RK-13



LEACHATE TANK

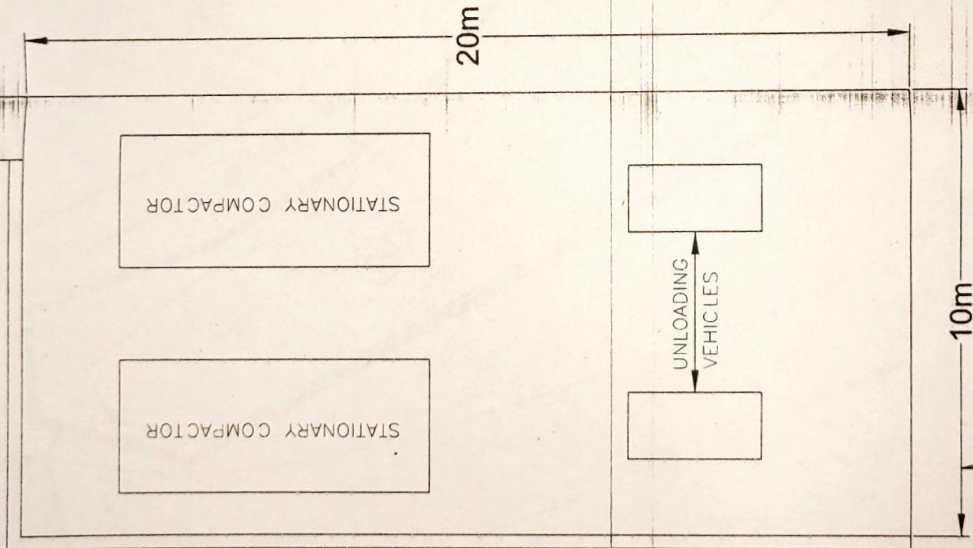

DO NOT SCALE FOR DPR PURPOSE ONLY

TYPICAL LAYOUT OF MSW TRANSFER CENTER

DATE	1.23	DATE	1.23
BY	SK	DATE	1.23
BY	SK	DATE	1.23
BY	SK	DATE	1.23
BY	SK	DATE	1.23

TATA CONSULTING ENGINEERS LIMITED
 IN ASSOCIATION WITH TROIC CONSULTANTS PVT. LTD.
 CLIENT: **UTARAKHAND ORGANIC SOLIDS MANAGEMENT PROJECT**
 PROJECT: **UTARAKHAND ORGANIC SOLIDS MANAGEMENT PROJECT**

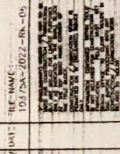

FILE NAME: 101/2017-022-00-00

FOR NO ISSUE ONLY

DEPT	CHECKED	DATE
CHEM		
CIVIL		
ELEC		
MECH		

Handwritten signature/initials

Handwritten signature/initials

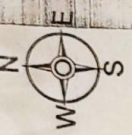

KEY PLAN

- LEGEND
- ENCLOSED ROAD
 - COMPOUND WALL
 - GREEN BELT

- NOTE
1. ALL DIMENSIONS ARE IN METER.
 2. TOTAL AREA OF PLANT = 6549 Sq.m
 3. TOTAL LENGTH OF P. ROAD = 298.7m
 4. TOTAL LENGTH OF CHANNEL ROAD = 456.0m
 5. TOTAL AREA OF GREEN BELT = 451.0 Sq.m

27 TNU WASTE PROCESSING FACILITY - COMPONENT LIST

Sl. No.	Component Name	Area (Sq. M)	Volume (Cu. M)
1	OFFICE	100	1000
2	WATER TREATMENT PLANT	1000	10000
3	WATER STORAGE TANK	1000	10000
4	WATER STORAGE TANK	1000	10000
5	WATER STORAGE TANK	1000	10000
6	WATER STORAGE TANK	1000	10000
7	WATER STORAGE TANK	1000	10000
8	WATER STORAGE TANK	1000	10000
9	WATER STORAGE TANK	1000	10000
10	WATER STORAGE TANK	1000	10000
11	WATER STORAGE TANK	1000	10000
12	WATER STORAGE TANK	1000	10000
13	WATER STORAGE TANK	1000	10000
14	WATER STORAGE TANK	1000	10000
15	WATER STORAGE TANK	1000	10000
16	WATER STORAGE TANK	1000	10000
17	WATER STORAGE TANK	1000	10000
18	WATER STORAGE TANK	1000	10000
19	WATER STORAGE TANK	1000	10000
20	WATER STORAGE TANK	1000	10000
21	WATER STORAGE TANK	1000	10000
22	WATER STORAGE TANK	1000	10000
23	WATER STORAGE TANK	1000	10000
24	WATER STORAGE TANK	1000	10000
25	WATER STORAGE TANK	1000	10000
26	WATER STORAGE TANK	1000	10000
27	WATER STORAGE TANK	1000	10000

WET WASTE PROCESSING UNIT'S COMPONENT LIST

Sl. No.	Component Name	Area (Sq. M)	Volume (Cu. M)
1	WATER STORAGE TANK	1000	10000
2	WATER STORAGE TANK	1000	10000
3	WATER STORAGE TANK	1000	10000
4	WATER STORAGE TANK	1000	10000
5	WATER STORAGE TANK	1000	10000
6	WATER STORAGE TANK	1000	10000
7	WATER STORAGE TANK	1000	10000
8	WATER STORAGE TANK	1000	10000
9	WATER STORAGE TANK	1000	10000
10	WATER STORAGE TANK	1000	10000
11	WATER STORAGE TANK	1000	10000
12	WATER STORAGE TANK	1000	10000
13	WATER STORAGE TANK	1000	10000
14	WATER STORAGE TANK	1000	10000
15	WATER STORAGE TANK	1000	10000
16	WATER STORAGE TANK	1000	10000
17	WATER STORAGE TANK	1000	10000
18	WATER STORAGE TANK	1000	10000
19	WATER STORAGE TANK	1000	10000
20	WATER STORAGE TANK	1000	10000
21	WATER STORAGE TANK	1000	10000
22	WATER STORAGE TANK	1000	10000
23	WATER STORAGE TANK	1000	10000
24	WATER STORAGE TANK	1000	10000
25	WATER STORAGE TANK	1000	10000
26	WATER STORAGE TANK	1000	10000
27	WATER STORAGE TANK	1000	10000

DO NOT SCALE DIMENSIONS ONLY FOR REFERENCE TO THE DRAWING. ALL DIMENSIONS ARE IN METERS UNLESS OTHERWISE SPECIFIED.

PROJECT NO. 27 TNU WASTE PROCESSING FACILITY - WASTE PROCESSING UNIT'S

TATA CONSULTING ENGINEERS LIMITED
IN ASSOCIATION WITH HODGSON CONSULTANTS PVT. LTD.

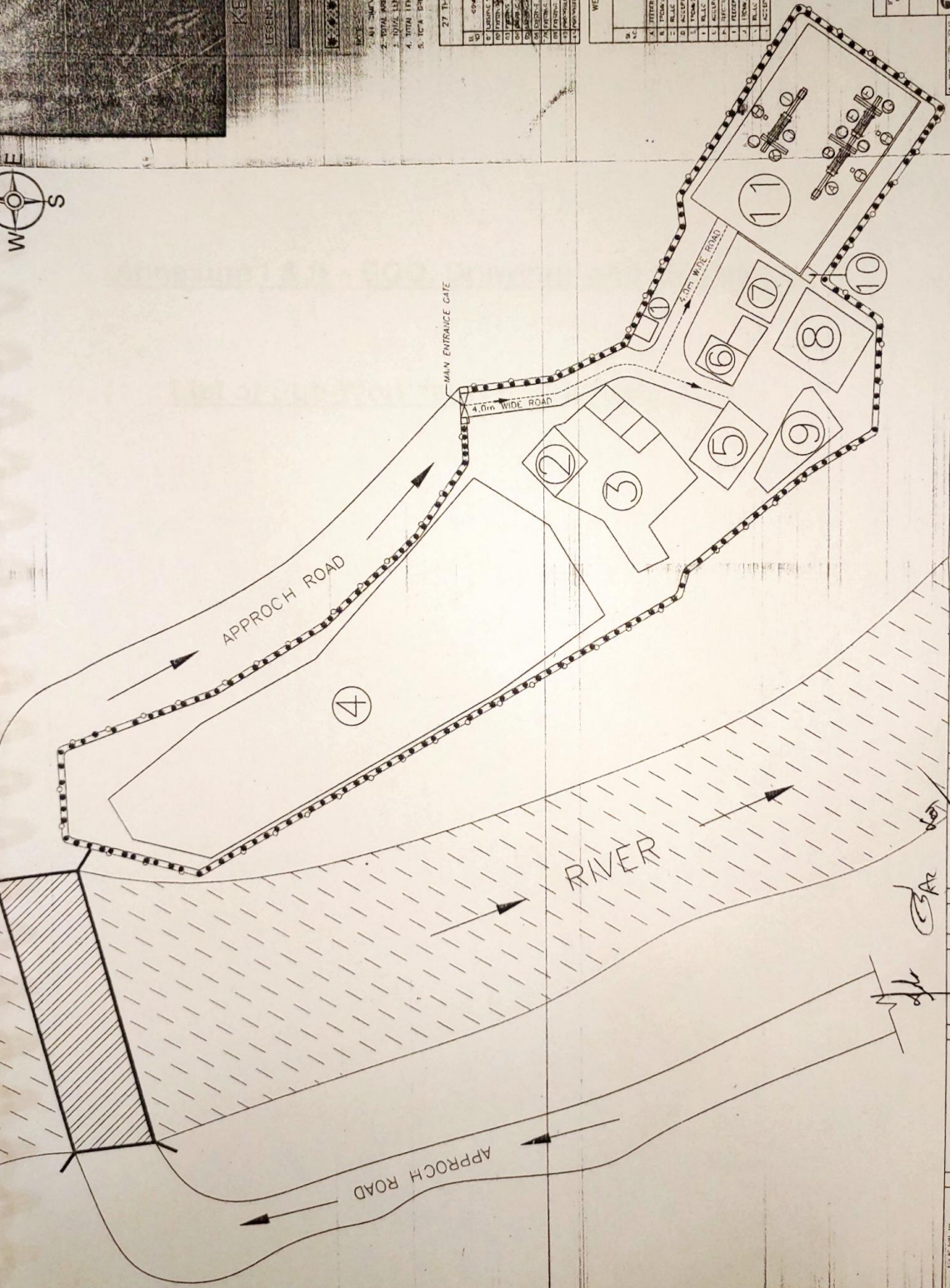

Sl. No.	Component Name	Area (Sq. M)	Volume (Cu. M)
1	OFFICE	100	1000
2	WATER TREATMENT PLANT	1000	10000
3	WATER STORAGE TANK	1000	10000
4	WATER STORAGE TANK	1000	10000
5	WATER STORAGE TANK	1000	10000
6	WATER STORAGE TANK	1000	10000
7	WATER STORAGE TANK	1000	10000
8	WATER STORAGE TANK	1000	10000
9	WATER STORAGE TANK	1000	10000
10	WATER STORAGE TANK	1000	10000
11	WATER STORAGE TANK	1000	10000
12	WATER STORAGE TANK	1000	10000
13	WATER STORAGE TANK	1000	10000
14	WATER STORAGE TANK	1000	10000
15	WATER STORAGE TANK	1000	10000
16	WATER STORAGE TANK	1000	10000
17	WATER STORAGE TANK	1000	10000
18	WATER STORAGE TANK	1000	10000
19	WATER STORAGE TANK	1000	10000
20	WATER STORAGE TANK	1000	10000
21	WATER STORAGE TANK	1000	10000
22	WATER STORAGE TANK	1000	10000
23	WATER STORAGE TANK	1000	10000
24	WATER STORAGE TANK	1000	10000
25	WATER STORAGE TANK	1000	10000
26	WATER STORAGE TANK	1000	10000
27	WATER STORAGE TANK	1000	10000

Annexure I & II – BOQ, Drawings and Quotations

List of Sub-Work for Narendranagr Town

Subwork 1: Procurement of Vehicles for MSW Collection and transportation (C&T) at Narendranagar
 Subwork 2: Information, Education and Communication activities proposed at Narendranagar Town

Sr. No.	Description	Amount INR (lakhs)		
		DSR	SOR	NSI
1	Vehicles	—	—	6.83
2	IEC	—	—	4.71

— — ₹ 11.54
 Add Cost Index
 Subtotal (A) — — —
 Contingency 3% — — — ₹ 11.54
 Sub total (B) — — —
 ₹ 11.54 lacs

 TATA CONSULTING ENGINEERS LTD.
 



Subwork 2: Information, Education and Communication activities proposed at Narendranagar Town

Sr. No	Activity	Activity Details	Unit	Estimated Quantity	Rate in INR.	Amount (in INR).	Remarks
A) Audio Media							
1	Production of Audio (success stories on SBM-U and awareness)	30secondRadioJingleswillbeproducedbytheconsultantonthetemes(i.e.ODF,handwashing,SWMawarenessandgoodpractices)to be identified by the client in Hindi/local language to be aired through All India Radio local stations	No	1	300000.00	300000	Market Survey, agencies contacted, 1- Channel Mountain, Dehradun,
D) Print Media							
5	Printing of awareness posters	Coloured (A3size, 170GSM GLOSSY/MATT LAMINATED) PAPER with photos, text regarding SWM Best Practices, Designing, Printing, Distribution among target groups in English, Hindi, based on the content supplied by the Client/ULB as described by the consultant in lots of 100, for each ULB	Lot	100	50	5000	Local rates to be collected
6	Printing of Newsletter	Coloured- 8pages (A4size) in 300GSM Glossy paper, with photos, text regarding SWM Best Practices and project information, Designing, Printing, Distribution among target groups in English, Hindi, based on the content supplied by the Client/ULB as described by the consultant, at least once in each quarter for each ULB, in lots of minimum 500 copies	No	500	12	6000	As per SPMG-NGCA
C) Mass Contact Program							
4	Street plays/ Nukkad Natak	Utilising folk arts forms, songs, dramas, entertainment performances etc, to which the local populace are able to identify, of minimum 30 minutes duration (in Hindi/local language) with at least 8-10 characters will be scripted by the agency focusing on different components of SBM and SWM "Good Practices" as adopted by communities. The play will have to be performed in various crowded places of ULBs by professional actors employed by the Consultant, in front of minimum 50 persons, at least once in each month in each ULB. The Consultant will also be responsible for designing, printing/preparation and fixing in place of 2 event banners, 10 awareness cloth banners (not flex/PVC) for each play, as approved by the client	No	3	10000	30000	
10	Seminar/ Workshop	ULB level seminars/workshops (Venue to be finalised and provided by Client/ULB free of cost), involving district/ block	No	3	5000	15000	

Sr. No	Activity	Activity Details	Unit	Estimated Quantity	Rate in INR.	Amount (in INR)	Remarks
		level officers concerned, NGOs, CBOs, researchers, academicians, prominent local people and public representatives, will be organized, by the consultant at least once in each ULB, focusing on "Good Practices" of SWM, with special focus on "Community Participation", (minimum 60 -75 participant) with all necessary Audio Visual equipment, refreshment, manpower essential to execute the activity. Prominent National Specialists will be engaged as individual consultants to address the gathering. Plastic & Thermocol disposal items is prohibited in all events					
	Press Briefing/ Press Event/Press Conference	Organising press event for 10-15 media at different locations. Preparation of press materials approved by Client/ULBs (Venue to be finalised and provided by Client/ULB free of cost) with stage (if required) backdrops, registration desk and audio-video equipment; refreshments for media. Media invitations RSV Pan give aways. Distribution of material to all local media and reporting on coverage	No	3	2500	7500	
11	Press Release	Finalising content and ensuring publicity by Press Release, as a tool of public awareness, as directed by the Client/ ULB	No	3	2500	7500	
12	Mobile based Outreach campaign.	Creation and execution of SMS/calling mobile outreach campaign reaching out to minimum of 10,000 people in each campaign, once in each quarter, in 24 ULBs.	No	Lumpsum		100000	
Total						471000	

SI-NIL
 ASI → 4.71

[Handwritten signature]

[Handwritten signature]

[Handwritten signature]